

FIBER CEMENT BOARD

Installation on concrete to accomodate rigid insulation

FIBER CEMENT BOARD

Welcome to the InstallMasters Fiber Cement Installation Manual. This guide provides essential instructions for a successful installation of fiber cement products. Following these guidelines will ensure a durable and aesthetically pleasing result. This manual is designed for professional contractors and offers step-by-step procedures to achieve the best outcome. Please read through this manual before starting your project and refer to it as needed.

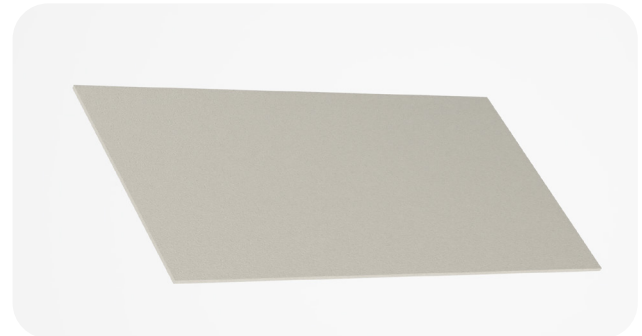

IM25

ACCESSORIES

THE ACCESSORIES REQUIRED FOR FIBER CEMENT



Joist

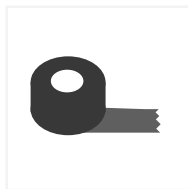

Flashing Tape

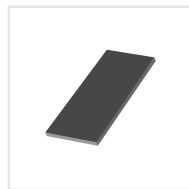

XPS Board



Fiber



Nail: Rust-proof steel
, 3.5*25mm



Masonry Screw



Mapesil-T

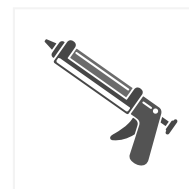

Silicone Caulk

THE INSTALLATION



1 Strapping must be a pressure treated lumber or exterior approved equivalent.

★ Use 3/6 x 3 1/4 inch masonry screws to fix pressure treated strapping to the concrete substrate.

★ Screws must be applied no further than 18" apart.

2 Strapping must be protruding out as far as the insulation being used to create a plumb surface to receive the fiber cement board.



A second layer of 1.5" x 3.5" pressure treat is fix to the first layer using 3" galvanized nails or 3" exterior rated screws. The spacing between can be no further than 18" apart.

★ Nails/screws must be no further than 18" apart, we suggest when doubling up on strapping to stagger your start points of the fasteners to avoid hitting previous fasteners when applying the second layer.



- 3** Xps will be cut to fit between the strapping see architectural drawings on xps fastening details.

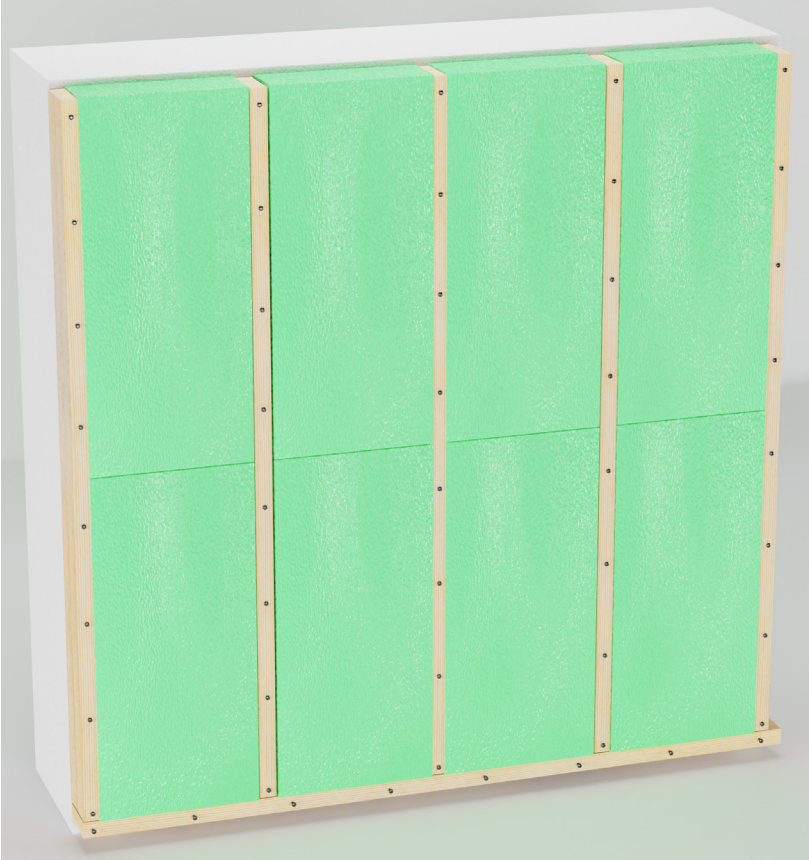

- 4** After the xps is installed use a 6" flashing tape to cover each butt joining of xps and to cover the strapping creating a completely sealed system. There should be no pressure treat exposed after this step.

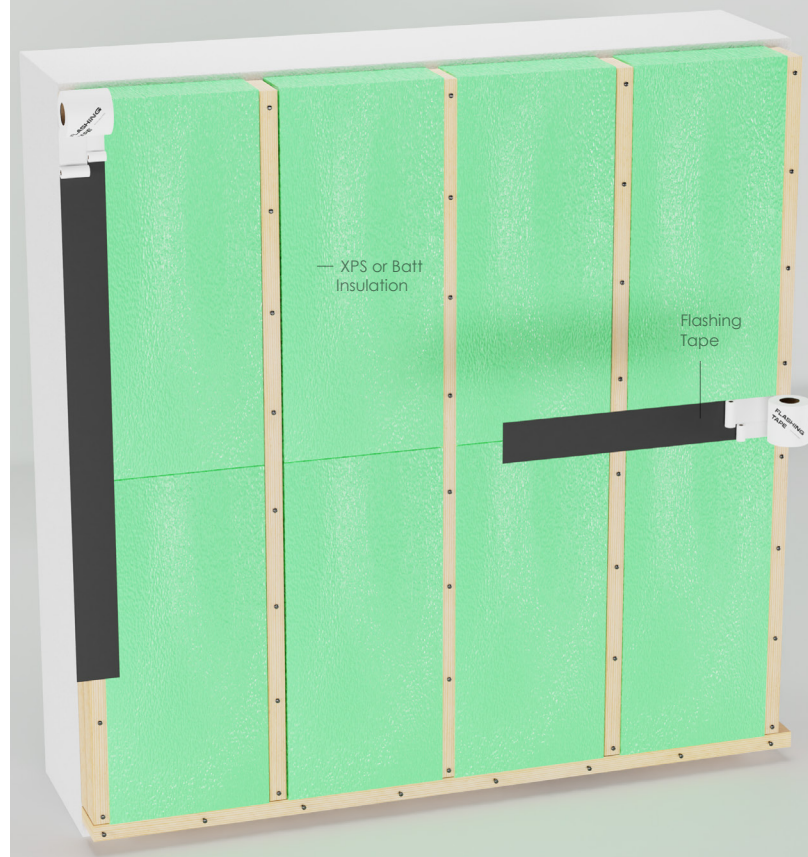

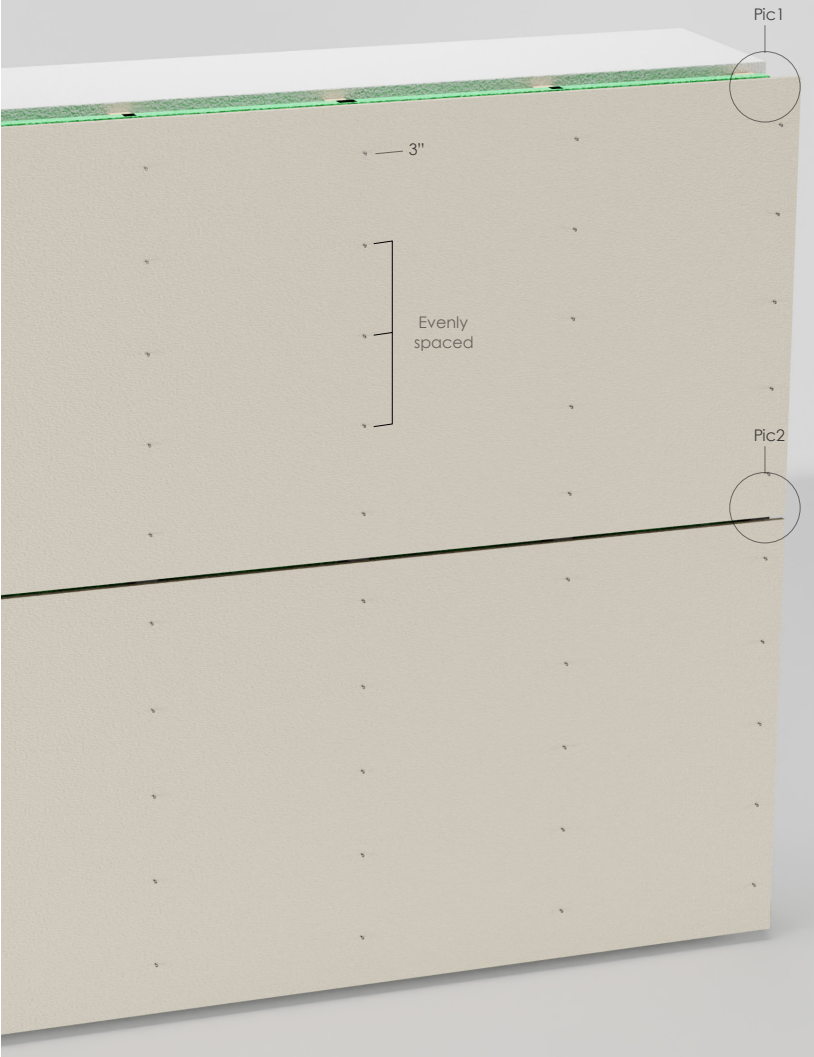

5 Attach the fibre cement panels to the strapping using 3.5" colour matched exterior rated screws.

★ We suggest after fastening at all 4 corners at your 3" in you space evenly the rest of your screws on the board. keeping the screws no further than 18" apart.
The screws will be exposed so take care to mark out and space evenly your screws.

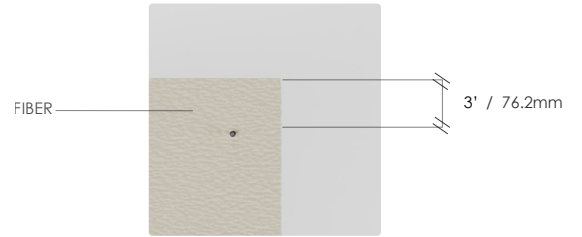

Pic1

★ There should be a 1/8 inch gap between each board.

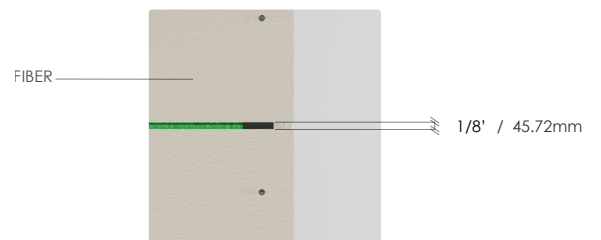

Pic2

6 Fill the space between two boards using Mapesil-T, which is a 100% silicone sealant with enhanced adhesion for heavy traffic and expansion/movement joints.

★ Bead of exterior caulking suggested mapesil-t or equivalent.

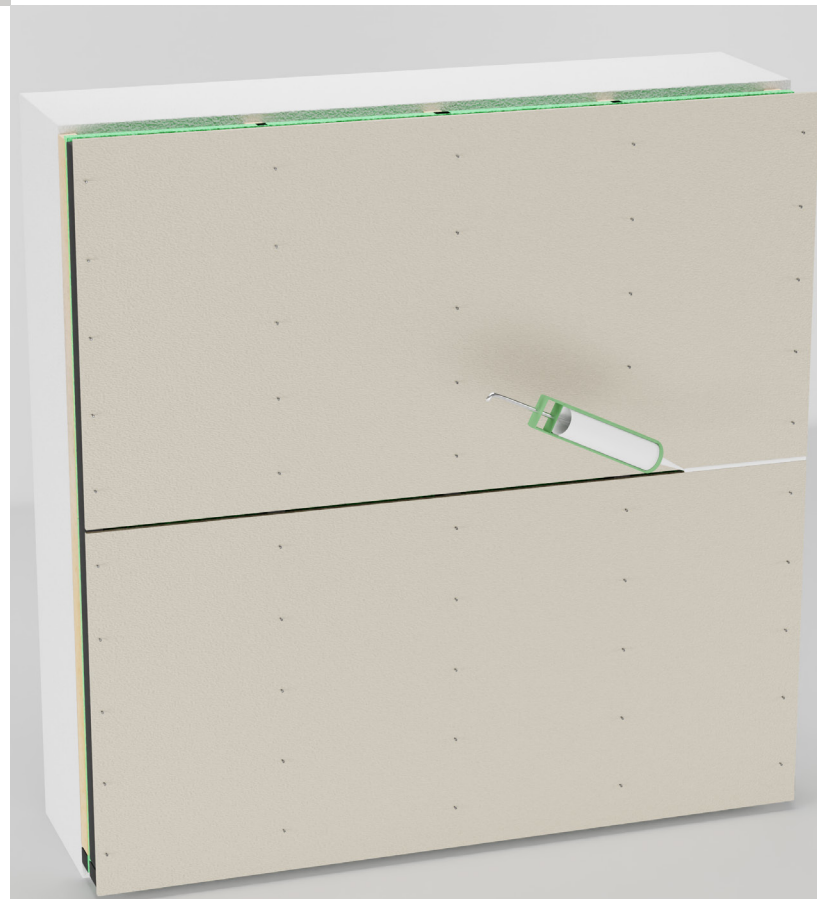

website



installmasters.ca

EMAIL

info@installmasters.ca

location

Unit 2, 290 Industrial Drive,
Saint John, NB E2R 1A5

phone

(506)898-1879
877 3718808 Ext: 101

(506)261-7152
877 3718808 Ext: 102

FOLLOW US



Instagram



Facebook



LinkedIn